

REAR QUARTER WINDOW PANEL INSTALLATION INSTRUCTIONS



INSTALLATION MANUAL: 2005-09 Mustang

P/N: 10-8002-C14865A

SALEEN

Saleen Performance, Inc. 1225 East Maple Rd. Troy, MI 48063 (800)-888-8945
www.saleen.com



***IF YOU ARE NOT EXPERIENCED IN THE AREA OF
AUTOMOTIVE MECHANICS, WE STRONGLY
URGE THAT YOU REFER THIS INSTALLATION TO
A CERTIFIED INSTALLER OR TECHNICIAN***



Rear Quarter Window Panel Installation Guide for 2005-09 Mustang

WELCOME!

Thank you for buying a Rear Quarter Window Panel Kit for the 2005-09 Mustang. We appreciate your business, and we hope you enjoy your product.

For your benefit, please read the following instructions completely and thoroughly before attempting to install a Rear Quarter Window Panel Kit. Many questions we have received from customers about the installation of our products could have been easily solved by information listed in this installation guide. We want you to enjoy the product in its fully functional state, and reading this tutorial is a great first step to getting you on your way to a more unique and attractive Mustang.

Again, thank you for choosing Saleen!



REAR QUARTER WINDOW PANEL KIT CONTENTS:

Item	Quantity Included in Kit
LH Rear Quarter Window Panel	1
RH Rear Quarter Window Panel	1

TOOLS REQUIRED FOR KIT INSTALLATION:

- Two-Handed Cold Knife with 90° blade (UltraWiz® #PN2002)
- Pinchweld Prep. Tool (Equalizer® #WP738)
- Caulk Gun
- 3/8" Drive Ratchet
- 15mm Socket (3/8" drive)
- Torx T-20 socket (3/8" drive)
- Torque Wrench (3/8" drive)

NOTE:

If you do not have any of the tools listed above, you may be able to obtain them from your local tool lending service. The cold knife and pinchweld prep. tool are available from Equalizer® at 800-334-1334, or from your local automotive glass supply source.

MATERIALS REQUIRED FOR KIT INSTALLATION:

- Urethane Adhesive (C.W. Lawrence Cat. No. PWR615HV)
- Pinchweld / Glass Primer (C.W. Lawrence Cat. No. PWR4P)
- "Paint Safe" masking tape

NOTE: Obtain the above materials from your local automotive glass supply source.

REAR QUARTER WINDOW PANEL INSTALLATION PROCEDURE:

Installation Overview

- Remove the original quarter window glass
- Remove excess urethane adhesive from the vehicle pinch weld sealing surface
- Use urethane adhesive to install the quarter window panels

NOTE: These instructions show how to install the passenger side (RH) quarter window panel (see Figure 1). Use these same instructions for the driver's side quarter window panel.

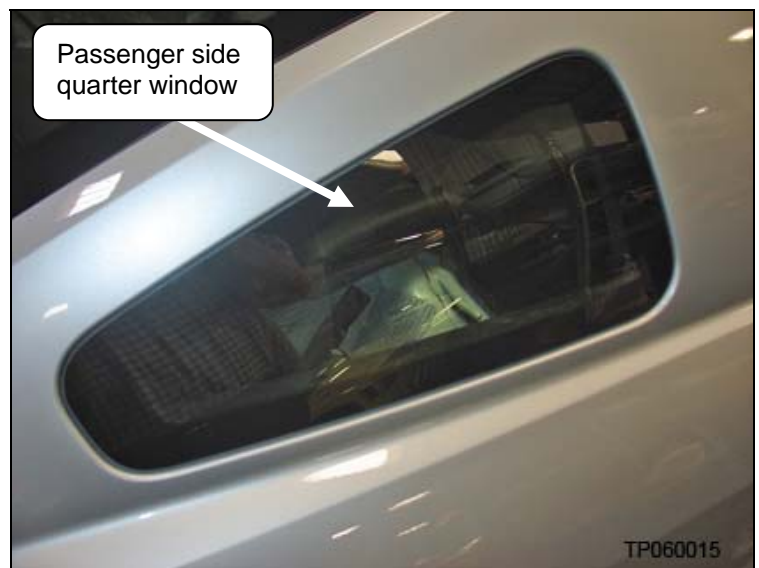

Figure 1

1. Place "paint-safe" masking tape around the quarter window opening. Then place two strips of tape across the glass and body to prevent the glass from falling out when cutting the urethane adhesive (covered later in this procedure). See Figure 2.



Figure 2

2. Remove the door sill plate by carefully lifting up to release the securing clips (see Figure 3).



Figure 3

3. Using a Torx T-20 bit and ratchet, remove the clothes hook from the upper portion of the "B" pillar (see Figure 4).
4. Using a 15mm socket and ratchet, remove the seat belt from the upper portion of the "B" pillar (see Figure 4).



Figure 4

5. Remove the quarter panel finisher (see Figure 5).

- Carefully pull out on the finisher to release the securing clips

NOTE: If you need to remove the rear seat to remove the finisher, refer to the applicable service manual for details.

6. Remove the quarter window finisher (see Figure 5).

- Carefully pull out on the finisher to release the securing clips

NOTE: If you need to remove the rear seat to remove the finisher, refer to the applicable service manual for details.

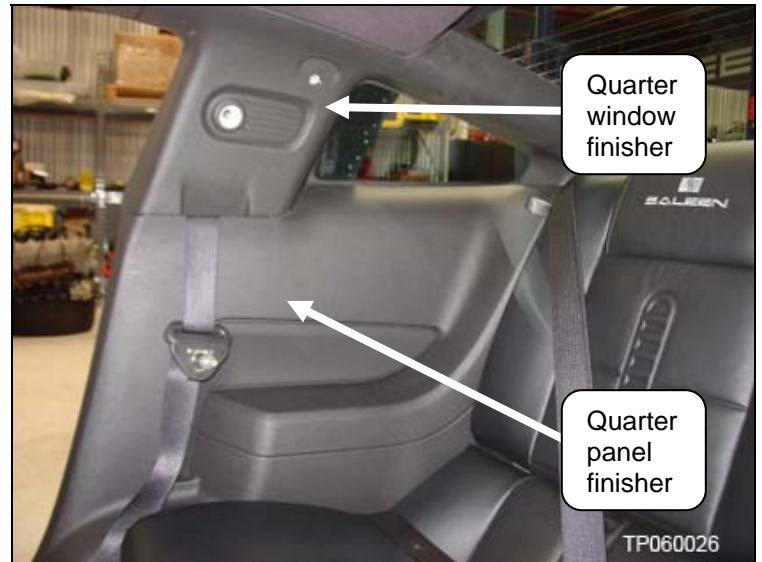

Figure 5

7. From inside of the vehicle, use a two-handed cold knife with a 90° blade to carefully cut the urethane around the perimeter of the quarter window glass (see Figure 6).

- Make sure you cut through the two plastic pins at each end of the glass
- Recommended cold knife: UltraWiz® #PN2002 (available from Equalizer®, 800-334-1334)

8. Carefully remove the glass.

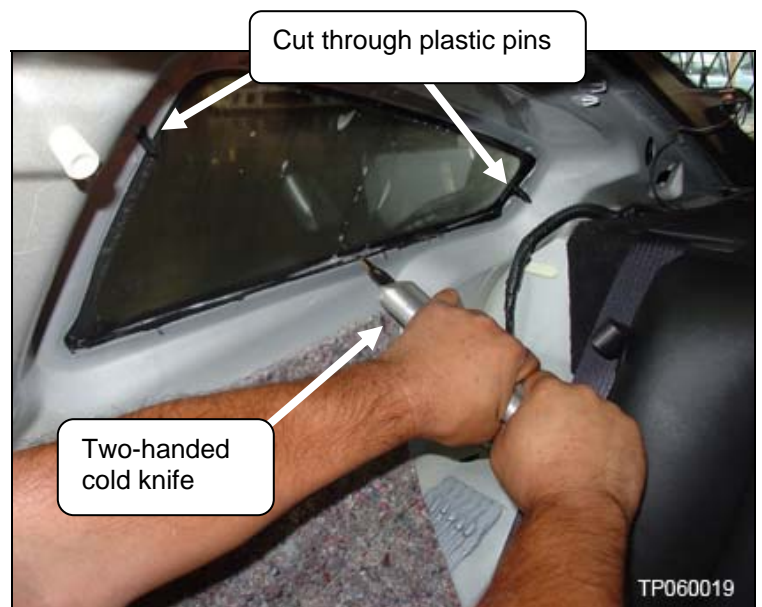

Figure 6

9. Using a pinchweld prep. tool, carefully trim the urethane leaving a 1mm to 2mm base of original urethane on the vehicle (see Figure 7).

- Be careful not to scratch the paint when removing the urethane
- Recommended pinchweld prep. tool: Equalizer® #WP738 (available from Equalizer®, 800-334-1334)

10. If needed, apply primer to any bare metal areas on the body/pinchweld.

- Use C.W. Lawrence Pinchweld / Glass Primer Cat. No.PWR4P
- Shake the primer for at least one minute before using
- Allow a minimum of 2 minutes for the primer to dry
- Re-apply primer if you wait longer than one hour to install the quarter window panel

11. Apply primer to the bonding surface of the quarter window panel (see Figure 8).

- Use C.W. Lawrence Pinchweld / Glass Primer Cat. No.PWR4P
- Shake the primer for at least one minute before using
- Allow a minimum of 2 minutes for the primer to dry
- Re-apply primer if you wait longer than one hour to install the quarter window panel

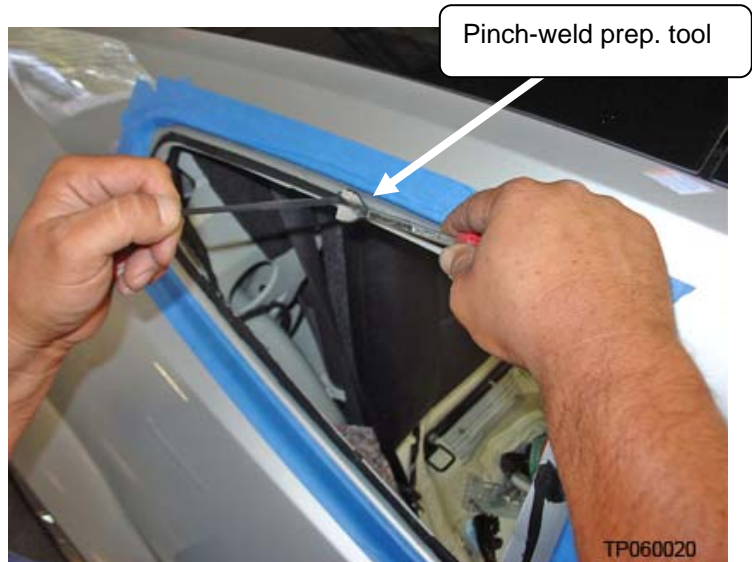

Figure 7

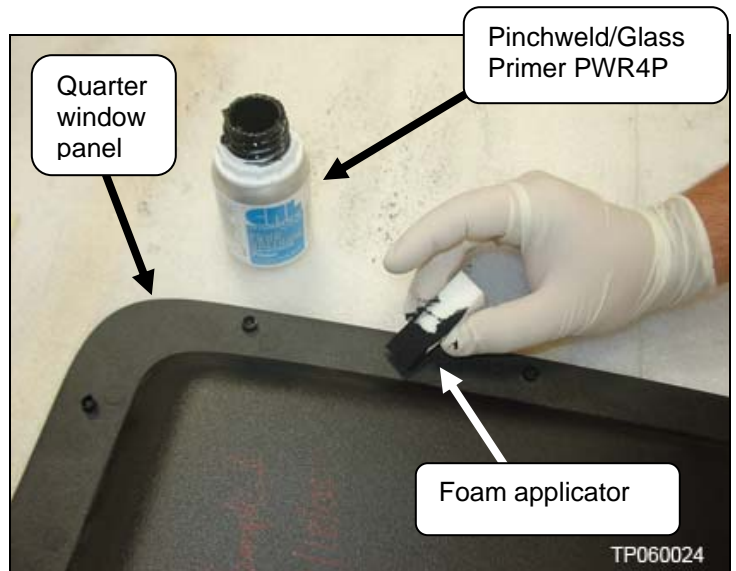

Figure 8

12. Apply a continuous (solid) bead of urethane adhesive to the bonding surface on the vehicle (see Figure 9).

- Use C.W. Lawrence Urethane Adhesive Cat. No. PWR615HV
- Triangle shaped bead size:
7mm wide x 15mm high



Figure 9

13. Install the quarter window panel, making sure:

- The slotted guides on the front and rear of the panel are inserted into the body hole/slot as shown in Figure 10
- The panel is fully seated
- Install 06-1101-C09949C, Quarter Window Panel RH, in the passenger side quarter window opening
- Install 06-1101-C09948C, Quarter Window Panel LH, in the driver's side quarter window opening



Figure 10

14. Apply “paint safe” tape over the panel seams to hold the panel in place during the adhesive curing time (see Figure 11).
 - Do not drive the car for one hour
 - Remove the tape after four hours
 15. Perform the above procedure on the other quarter window.
 16. Water test to check for leaks.
 17. Re-install all components in the reverse order of removal.
 18. Tighten the seat belt anchor bolts to **35 ft-lb.**
-



Figure 11